

FILTER - INLINE

- ALUMINIUM DIE CAST CONSTRUCTION
- 3 BASIC MODELS - FLOWS TO 150 LPM
- BY PASS STANDARD 1 BAR
- WORKING PRESSURE TO 20 BAR / TEST 30 BAR / BURST 40 BAR
- MAX TEMP. TO 80° C
- SUITABLE FOR MINERAL / PETROLEUM BASED OILS

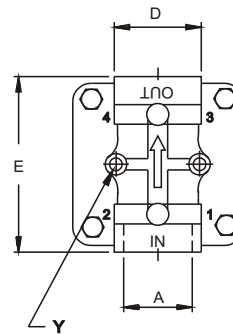
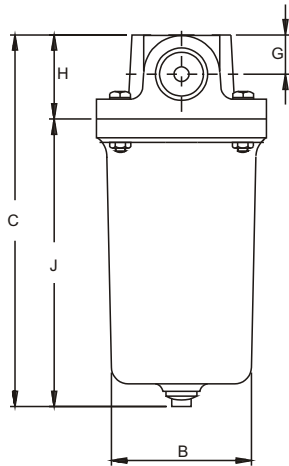

MODEL	PORT 'A' BSPP	B	C	D	E	G	H	J	Y 2 OFF	ELEMENT AREA (SQ.CMS.)		WT KGS
										10 / 25 m PAPER	149 m SS MESH	
HF * . 05	1 / 2"	66	149	38	88	21	44	105	M 8	920	315	0.9
HF * . 10	3/4" 1"	87	185	44	114	23	50	135	M 8	2206	774	1.8
HF * . 20	1 - 1 / 4" 1 - 1 / 2"	118	300	57	142	31	65	235	M 10	7237	2096	3.6

FILTER - INLINE



MODEL CODE : ASSEMBLY

HF	R	- 05	- 04	B	- 010	- **
TYPE	SIZE	PORT INCH	THREAD	FILTRATION μ MICRONS	FEATURE SPECIAL #	
R - RETURN	05	04 - 1/2"	B - BSPP (STD)	010 - 10 μ NOM		
S - SUCTION		06 - 3/4"		025 - 25 μ NOM		
B - NO BYPASS		08 - 1"	N - NPT (OPTIONAL)	A10 - 10 μ ABS		
	10	10 - 1-1/4"	S - SAE (OPTIONAL)	A25 - 25 μ ABS		
		12 - 1-1/2"		149 - 149 μ NOM		
		20		74 - 74 μ NOM		

INDICATOR PORTS

- B - 4 X 1/8" NPT INLET/OUTLET
- R - 2 X 1/8" NPT INLET
- S - 2 X 1/8" NPT OUTLET
- X - NONE (OPTIONAL #)

OIL VISCOCITY 32 cSt @ 30° C

Ⓐ - 10 MICRONS Ⓑ - 25 MICRONS Ⓒ - 149 MICRONS

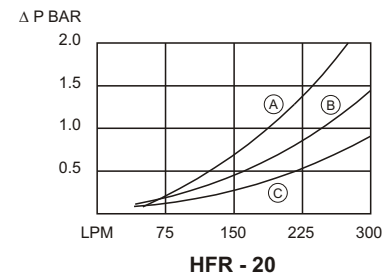
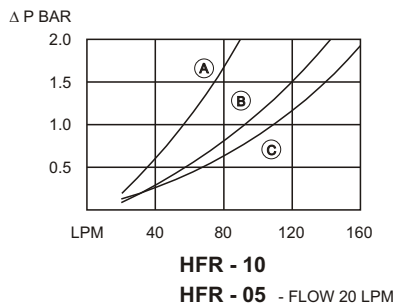

MODEL CODE : ELEMENT

HFE	- 05	- 010
	SIZE	FILTRATION μ MICRONS
HFE	05	010 - 10 μ NOM
		025 - 25 μ NOM
	10	A10 - 10 μ ABS
		A25 - 25 μ ABS
	20	149 - 149 μ NOM
		74 - 74 μ NOM

INDICATOR : OPTIONAL (TO BE ORDERED SEPERATELY)

- GR - VISUAL RETURN
- GS - VISUAL SUCTION

- ER - ELEC. RETURN
- ES - ELEC. SUCTION

OPTIONAL / SPECIAL FEATURE - OMIT IF NOT REQUIRED
 CONSULT FACTORY FOR β₁ = 75 (ABSOLUTE) RATED ELEMENTS AVAILABILITY

FILTER - INLINE

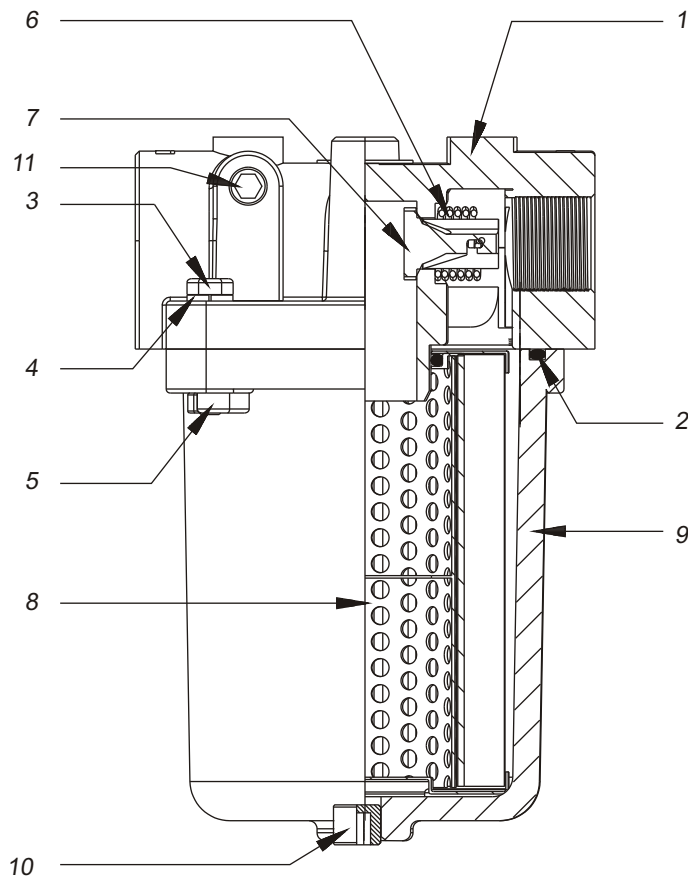

Item No	Part Name	Qty	HFR - 05	HFR - 10	HFR - 20
1	Head(ReferModelCode)	1			
2	Bowl O Ring	1	68.0x2.5	82.0x3.5	115.0 x 3.0
3	Bolt	4	M6 x 30	M6 x 30	M8 x 45
4	Spring Washer	4	M6	M6	M8
5	Nut	4	M6 x 1	M6 x1	M8 x 1.25
6	Check Valve Spring	1			
7	By Pass Valve	1	Built in		
8	Element(Refer Model Code)	1			
9	Bowl	1			
10	Drain Plug	1	1 / 4"NPT	1 / 4"NPT	3 / 8"NPT
11	Grub Screw 1/8" NPT	2			

O Ring Size - Internal Dia mm x Cross Sectional Dia mm